

The New

# dina meri®

Manufacturer of Professional Beauty Equipment

## EASY-ROLL Roll-up door replacement instruction



Remove the old door by carefully pulling it off the tracks. Pay attention not to damage the sides of the unit.

Remove all the trays from the unit.

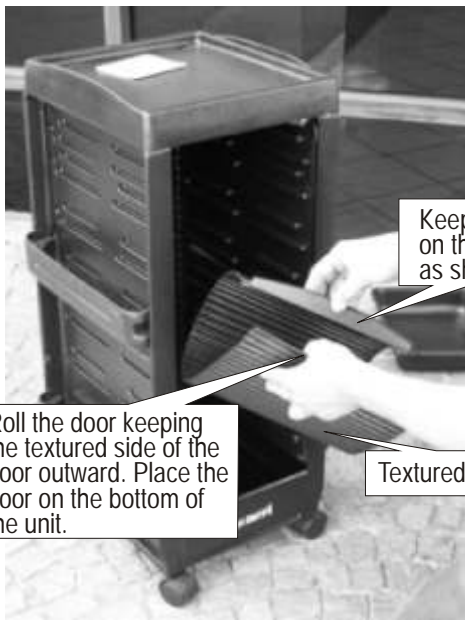

Keep handle on the inside as shown

Roll the door keeping the textured side of the door outward. Place the door on the bottom of the unit.

Textured side



Push the door to the bottom of the unit. It is ok for it to look like this. Keep the front 2 corners close to the beginning of the track.

Beginning of the track on each side



Feed the door through the side track and slowly pull upward.



Keeping the door within the tracks pull it all the way until it reaches the top

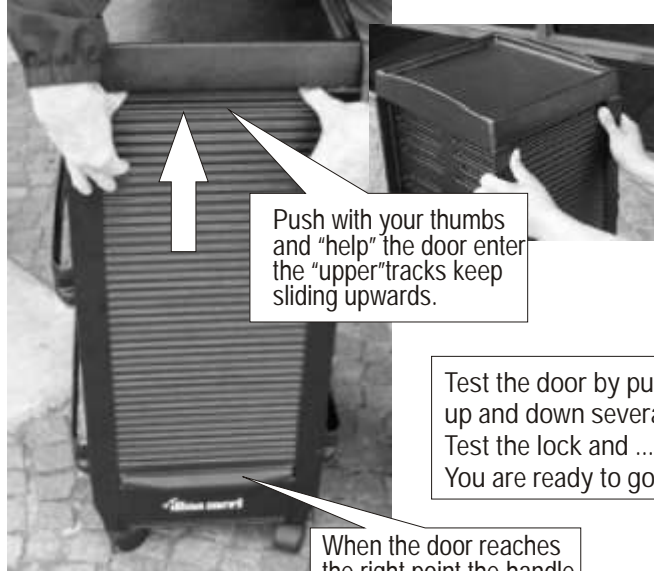

Push with your thumbs and "help" the door enter the "upper" tracks keep sliding upwards.

Test the door by pulling up and down several times. Test the lock and ..... You are ready to go!

When the door reaches the right point the handle will pop out making a "snapping" noise.